

Thank you for purchasing our  
**Cresco 10SW Assembled  
Fertilizer and Salt Spreader**



**We're delighted to have you as a customer  
and are here to help! First off, let's get your  
product assembled!**

**Table of Contents:**

- 1:** Spare Parts
- 2-4:** Assembling your Cresco 10SW
- 5-7:** Slide System Explanation
- 8-11:** How to Use the Cresco 10SW
- 12:** Application Guide for Fertilizer
- 13:** Warranty

**Scan for video assembly:**



# Spare Parts

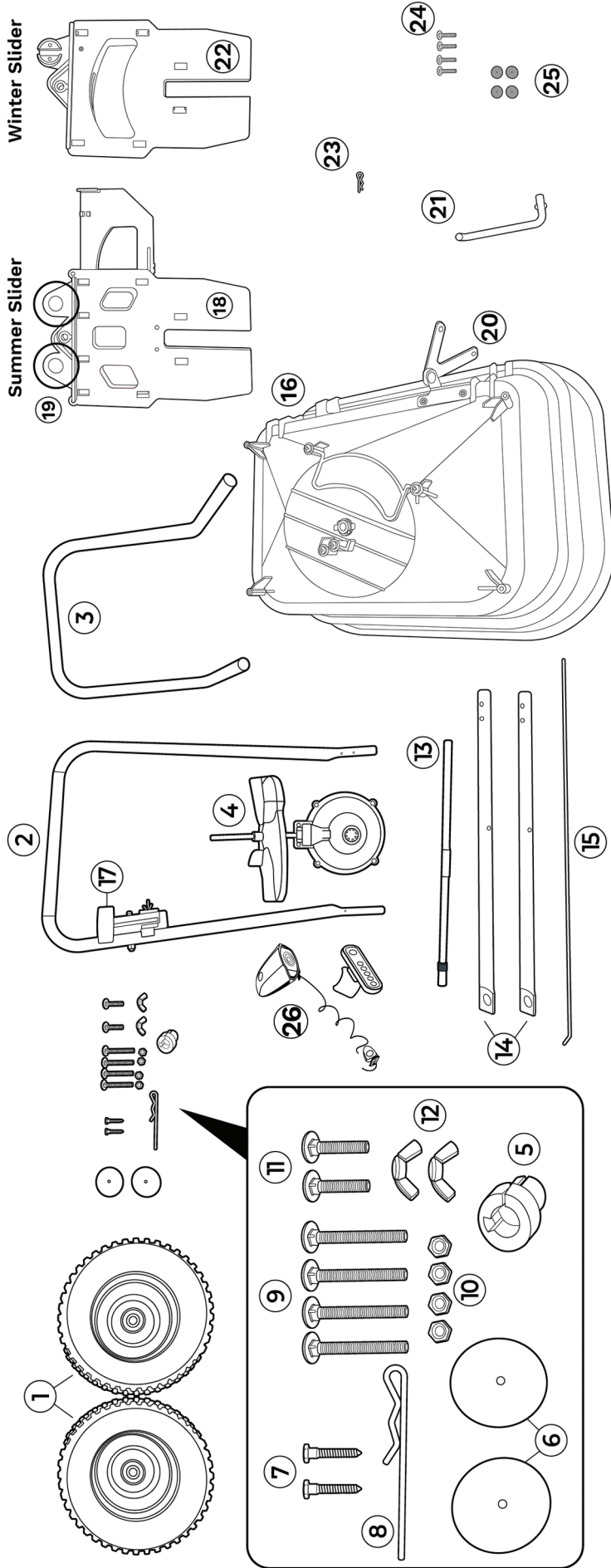

**Empty all contents of the box onto a flat surface and count parts to make sure all are there.**

## CRESO 10 PARTS LIST:

- |                                                                                       |                                   |                          |
|---------------------------------------------------------------------------------------|-----------------------------------|--------------------------|
| <b>1.</b> Wheel (X2)                                                                  | <b>15.</b> Control Rod            | <b>23.</b> R-pin Small   |
| <b>2.</b> Handle Bar                                                                  | <b>16.</b> Hopper Body            | <b>24.</b> 4x Screws     |
| <b>3.</b> Stand                                                                       | <b>17.</b> Control Lever          | <b>25.</b> 4x Washers    |
| <b>4.</b> Gear box and Impellor                                                       | <b>18.</b> Summer Slider          | <b>26.</b> Safety Lights |
| <b>5.</b> Axle bearing (X2) (One is on the axle, the second one is in the parts pack) | <b>19.</b> Adjustors (Left/Right) |                          |
| <b>6.</b> Plastic Wheel Caps                                                          | <b>20.</b> Pivot Bracket          |                          |
| <b>7.</b> Wheel Cap Screws                                                            | <b>21.</b> Lower Linkage          |                          |
|                                                                                       | <b>22.</b> Winter Slider          |                          |

**Scan to view and purchase spare parts:**



# Slide System **Explanation**

**\*\*\* VERY IMPORTANT \*\*\***

**Your Cresco spreader comes with two different application sliders.**  
One is for **winter** and the other is for **summer!**



**DO NOT SPREAD FERTILIZER  
WITH THE WINTER SLIDER**

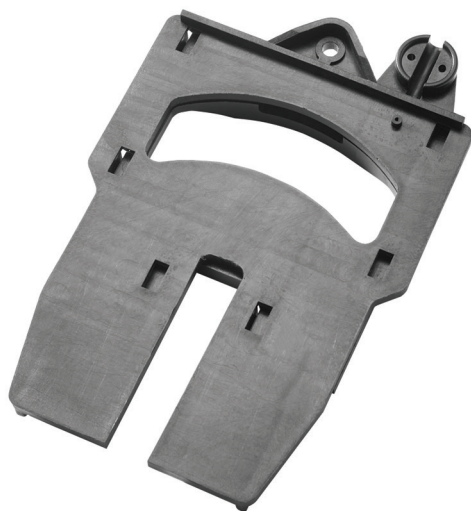

**Winter Slider**

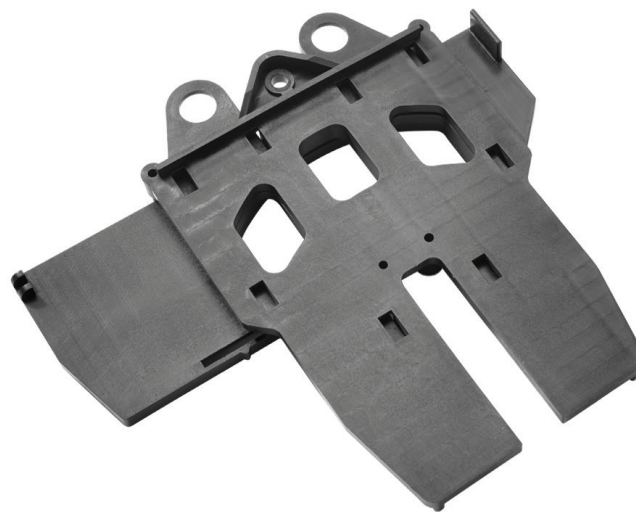

**Summer Slider**

**Please locate and choose your slider.**

# Assembling your **Cresco 10SW**

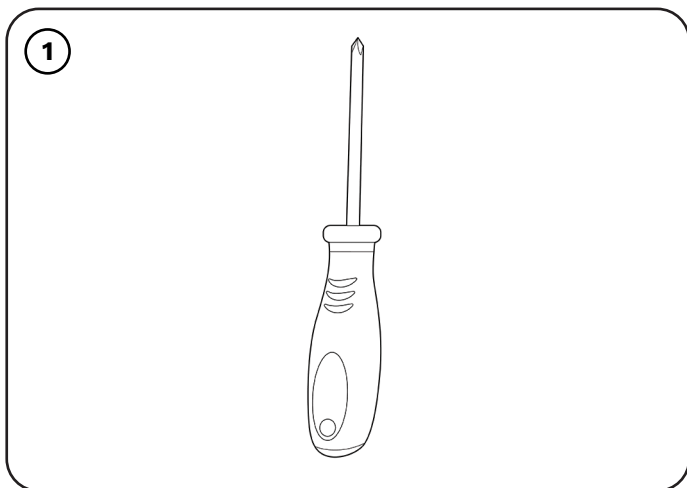

Tools you'll require to assemble your CR10SW.

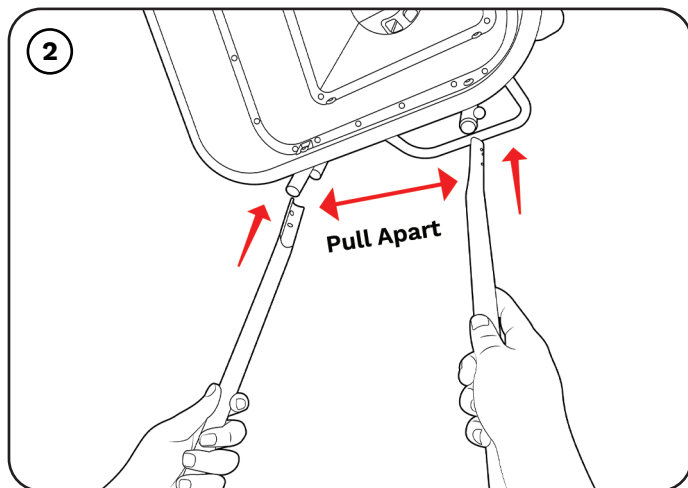

Align the holes at the bottom of the handle bar (item 2) with the holes at the top of the lower frame (item 14). You may need to pull the ends apart slightly to place in position.

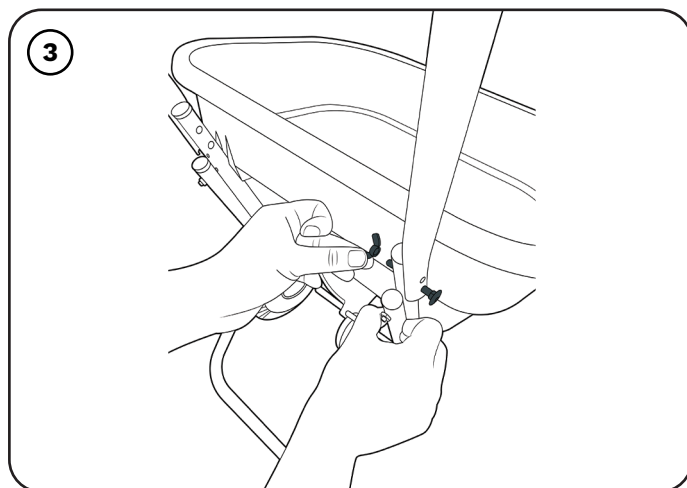

Thread the M6x35 bolt (11) through the hole of the handle bar (item 2) and lower frame (item 14). Use the M6 wingnut (12) to tighten. Repeat on both sides.

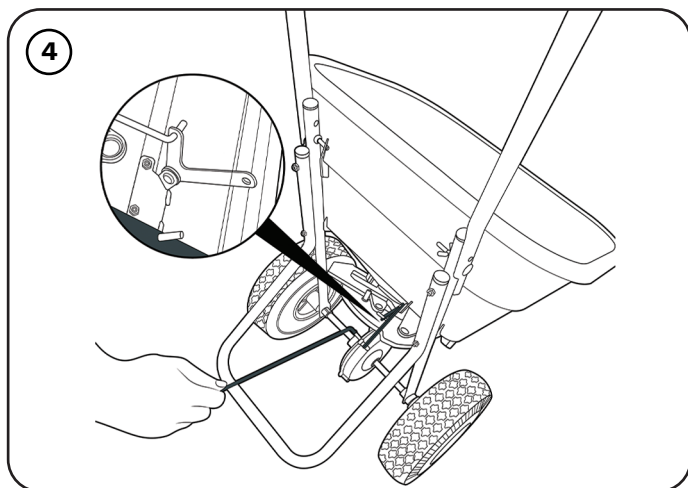

Protruding from the back of the hopper body (item 16) is a V-shaped metal (pivot bracket) (item 20). Clip the pivot bracket end of the control rod (item 15) into the hole on the V-shaped metal.

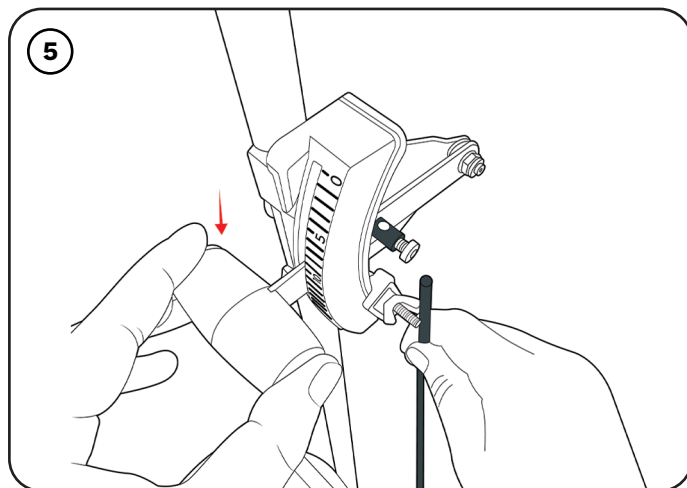

Feed the other end of the control rod (item 15) through the hole at the back of the control lever (item 17). Make sure you push the lever all the way to the bottom.

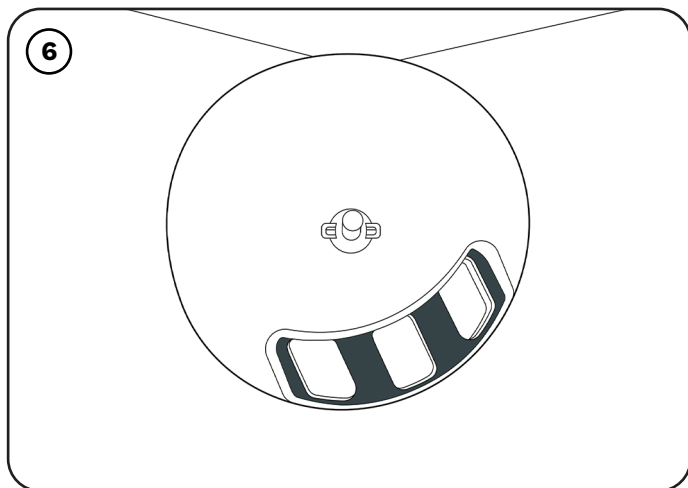

Before tightening the control rod. Make sure the application holes in the hopper are fully open and the control lever is set at 20.



## Assembling your **Cresco 10SW**

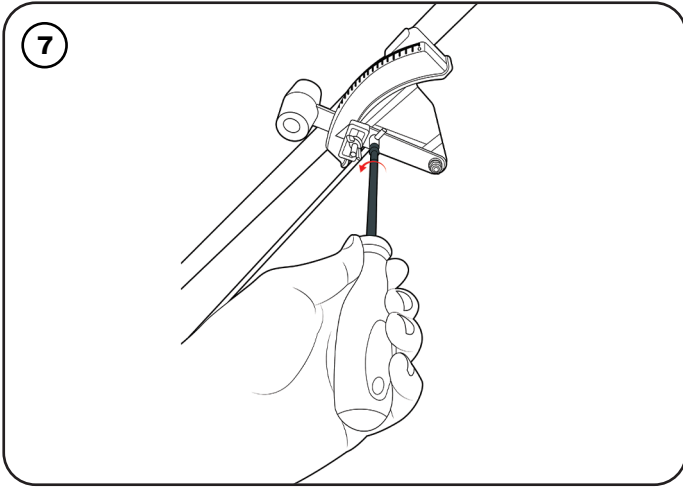

Tighten the control rod.

# Slide System **Explanation**

## **Winter**

For spread width 6 meters.



Pavement setting (2 meters).



## **Ice Melts**





## **Summer**

The summer slide system comes with 20 different settings and a border control. This slider provides control over the accuracy of your spreading.

Large/Heavy Materials

Small/Light Materials

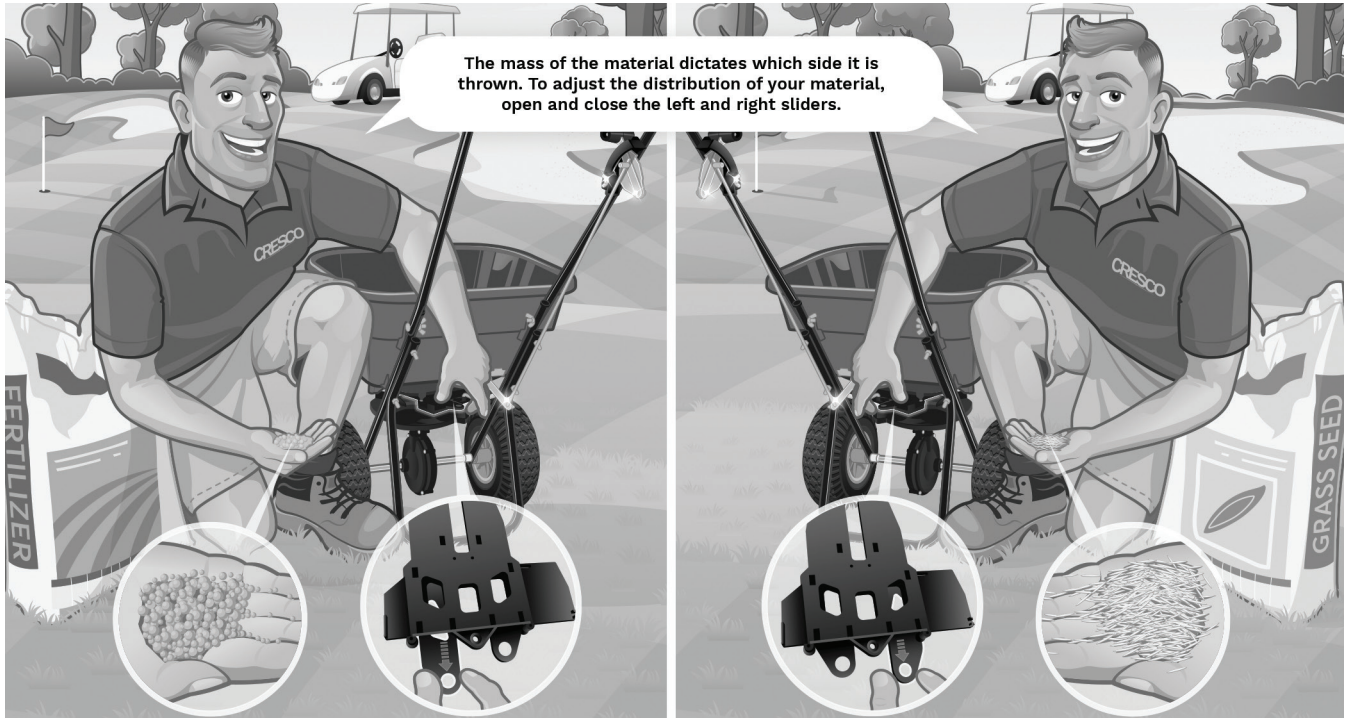

## **Border Control**



To protect your borders simply slide the border control into position to cut off the left hand side of the spread pattern.

# Slide System **Explanation**



**SLIDE-SYSTEM  
TECHNOLOGY  
SETTINGS**

**TWO SEASONS.  
ONE SPREADER.**



PRODUCT		SUMMER SLIDER	SLIDER ADJUSTER SETTINGS	
	<b>POWDERED OR MICRO GRANULAR FERTILIZER</b>		<b>NO ADJUSTMENT OF EITHER SLIDER RECOMENDED</b>	
	<b>MEDIUM GRANULAR FERTILIZER</b>		<b>NO ADJUSTMENT OF EITHER SLIDER RECOMENDED</b>	
	<b>LARGE GRANULAR FERTILIZER</b>		<b>ADJUSTMENT OF THE LEFT SLIDER RECOMENDED 6-7 CLICKS</b>	
	<b>GRASS SEED OR VERY LIGHT MATERIALS</b>		<b>ADJUSTMENT OF THE RIGHT SLIDER RECOMENDED 3-4 CLICKS</b>	
	<b>PELLETED MATERIALS</b>		<b>ADJUSTMENT OF THE LEFT SLIDER RECOMENDED (SELECT CLOSED)</b>	
	<b>LARGE GRANULAR ICE MELTS</b>		<b>ADJUSTMENT OF THE LEFT SLIDER RECOMENDED (SELECT CLOSED)</b>	
<b>WINTER SLIDER</b>				
<b>** Please note this chart is a guide only. Due to variations in the spreading characteristics of materials, accurate calibration should be carried out by the operator for each different materal being applied.**</b>				
	<b>SHARP SAND</b>		<b>FULL OR REDUCED WIDTH SLIDER OPTION RECOMENDED</b>	
	<b>FLOWABLE SAND / SOIL MIX</b>		<b>FULL SLIDER WIDTH USE RECOMENDED</b>	
	<b>COARSE MARINE SALT</b>		<b>FULL OR REDUCED WIDTH SLIDER OPTION RECOMENDED</b>	
	<b>ROCK SALT</b>		<b>FULL SLIDER WIDTH USE RECOMENDED</b>	
	<b>GRIT MATERIALS</b>		<b>FULL SLIDER WIDTH USE RECOMENDED</b>	

[WWW.CRESCOSPREADERS.COM](http://WWW.CRESCOSPREADERS.COM)

DMMP Limited is not responsible for misaplication due to incorrect use or incorrect calibration of Cresco spreaders, and any other DMMP Limited spreader brands.

For calibration information please refer to "how to calibrate" section on the Cresco website.





# How to use the **Cresco 10SW**

## How to Apply Fertilizer to your lawn like a pro in four steps!

**Step 1:** Understanding the application rate and settings

**Step 2:** Preparing the Spreader

**Step 3:** Walking Patterns for the optimum application

**Step 4:** Cleaning & Maintenance

## Step 1: Understand the application rate and settings

### Application Rate Settings

Check the back of the fertilizer bag to find out the recommended G/m<sup>2</sup> and spreader application setting.



If the spreader setting is not on the back of the bag, please get in touch with your fertilizer bag provider.



Set the handle to the correct setting.

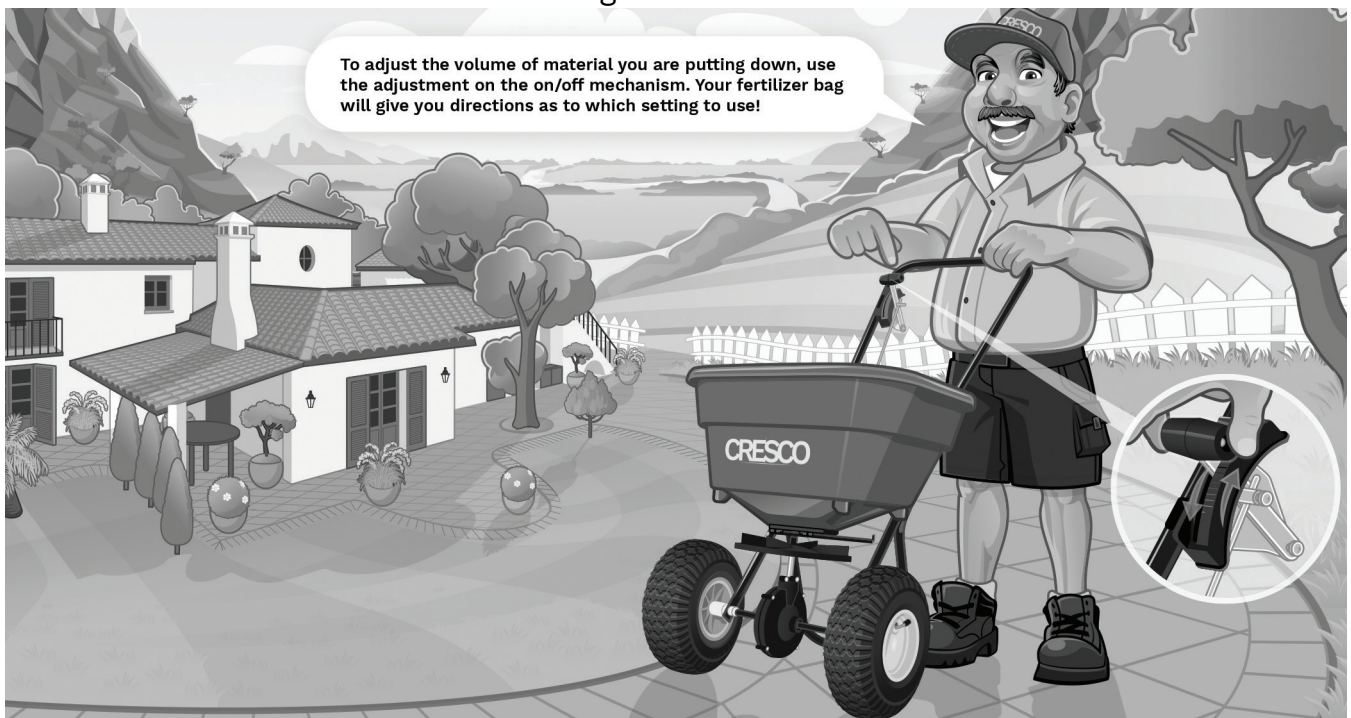

If you are unable to find the required Cresco volume setting, please visit, [www.crescospreaders.com](http://www.crescospreaders.com)

# How to use the Cresco 10SW

## **Spread Pattern Settings**

Once you have the correct application rate, you will need to check that the spread of material is even on both sides of the spread pattern.

To balance the spread pattern for your material, check online or with your fertilizer or seed provider.

For a quick reference, please refer to our guide on the previous page.



The chart is titled "CRESCO SLIDE-SYSTEM TECHNOLOGY SETTINGS" and "TWO SEASONS. ONE SPREADER." It shows a spreader on a lawn. Below the title are two icons of sliders. The chart is organized into three columns: PRODUCT, SUMMER SLIDER, and SLIDER ADJUSTER SETTINGS. The first row shows "POWDERED OR MICRO GRANULAR FERTILIZER" with a pile of powder, a slider icon, and the text "NO ADJUSTMENT OF EITHER SLIDER RECOMENDED" with a slider icon. The second row shows "MEDIUM GRANULAR FERTILIZER" with a pile of granules, a slider icon, and the text "NO ADJUSTMENT OF EITHER SLIDER RECOMENDED" with a slider icon.

PRODUCT	SUMMER SLIDER	SLIDER ADJUSTER SETTINGS
 POWDERED OR MICRO GRANULAR FERTILIZER		NO ADJUSTMENT OF EITHER SLIDER RECOMENDED 
 MEDIUM GRANULAR FERTILIZER		NO ADJUSTMENT OF EITHER SLIDER RECOMENDED 

## **Step 2: Preparing the Spreader**

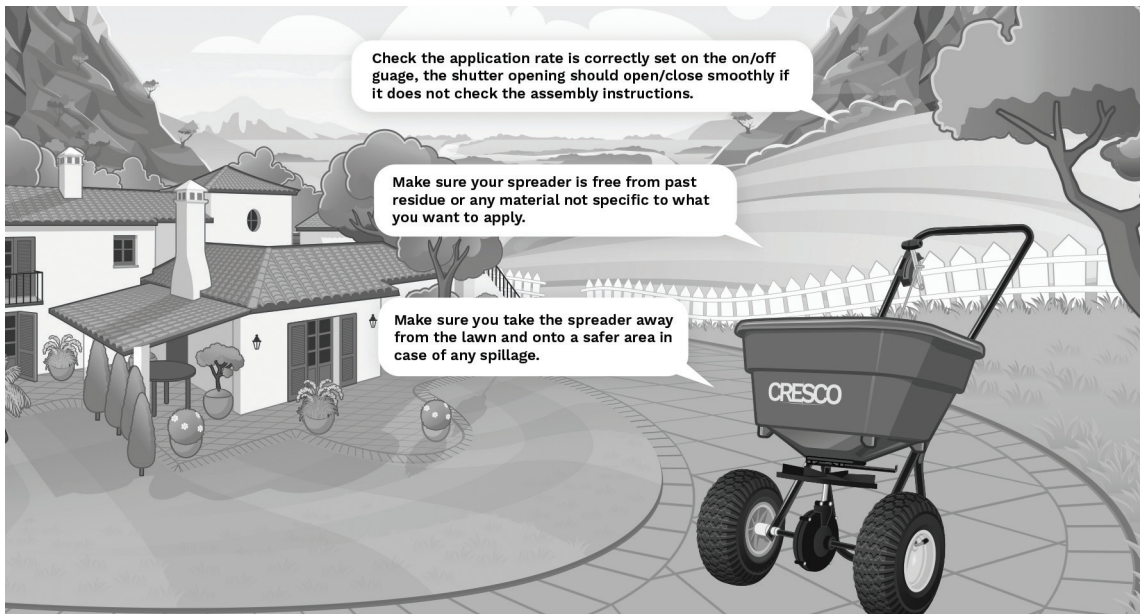

Check the material to be applied is dry and free flowing to ensure it will flow freely through the hopper. Make sure your application rate and spread pattern settings are correct, **close the application hole fully** and then pour in your material.

## How to use the **Cresco 10SW**

Your outlet hole should look like this before you pour in any material.



It is preferable to spread when the weather is dry, however a rain cover can be added to your spreader to ensure the material in your hopper is not exposed to moisture.



**WARNING \*\*Do not pour material in the hopper when the application holes are open as it can lead to spillages or leaks that can damage the area. Do not open the gauge until you are over the area you want to spread and are moving at a brisk walk\*\*\***

### **Step 3: Walking Patterns for the optimum application (For Fertilizer Only)**

There are two methods of effective spreading, longitudinal fertilizer spreading and cross sectional fertilizer spreading.

**When applying fertilizer please make sure you walk at 3mph and keep the hopper in a stable, upright position.**



# How to use the **Cresco 10SW**

## Single Pass Fertilizer Spreading

Use ½ the application rate suggested on the back of your fertilizer bag.

Cover the area as shown by passing over it in an up and down track as shown, taking into account the spread width of the material being applied.

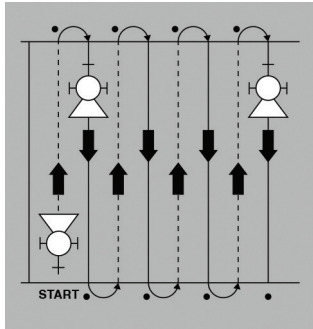

## Cross Sectional Fertilizer Spreading

Use ½ the application rate suggested on the back of your fertilizer bag.

Cover the area as shown. Repeating by a second pass in the same manner going across the area as shown in the diagram.

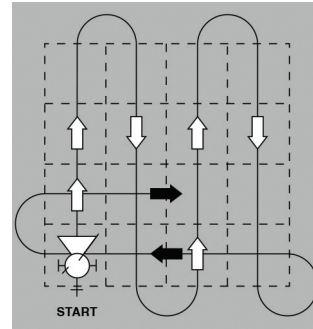

## Step 4: Cleaning and Maintenance

**CLEANING THE SPREADER THOROUGHLY WILL SIGNIFICANTLY ENHANCE THE LIFESPAN OF YOUR SPREADER AND IMPROVE IT'S ABILITY TO SPREAD EVENLY NEXT TIME YOU USE IT.**





## Calibration Setting Guide

Speed		05mm - 1mm			1mm - 2mm			3mm - 5mm		
Mph	3	3.5	3.5	3.5	4.0	4.0	4.0	4.5	4.5	4.5
Kph	4.828	20	35	50	20	35	50	20	35	50
Metres p/ Sec	1.34	10	10	10	10	10	10	10	10	10
<b>Width</b>	<b>Metres</b>	13.4	13.4	13.4	13.4	13.4	13.4	13.4	13.4	13.4
<b>Application Rate</b>	<b>Grams /Sq M</b>	47	47	47	54	54	54	60	60	60
<b>Run Time</b>	<b>Secs</b>	938	1,876	3,015	938	1,876	3,015	938	1,876	3,015
<b>Distance</b>	<b>metres</b>	8.5	11	14	11	13.5	19.5	13	18	16 (X2)
<b>Area</b>	<b>Sq Metres</b>	-	-	-	-	-	-	7 Clicks LHS	7 Clicks LHS	7 Clicks LHS
<b>Target Weight</b>	<b>Grams</b>	-	-	-	-	-	-	-	-	-
<b>Setting</b>	<b>Slider Position</b>	-	-	-	-	-	-	-	-	-

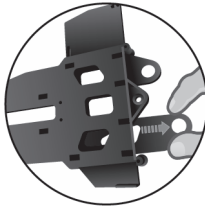

Left hand slider adjuster

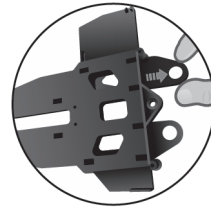

Right hand slider adjuster

LHS (Left hand slider adjuster) is recommended to be engaged when spreading large sized granular materials to provide a more uniform distribution on the left and right side of the spread pattern. Conversely with very light materials (e.g. grass seed) engaging the RHS (Right hand slider adjuster) will be similarly beneficial.

\*Do not spread Fertiliser or seed materials with the winter slider\*

**This chart should be used as a guide only.**

The manufacturer cannot be held responsible for any variations in sq. metre application volumes, or spread width differences, due to possible variations in materials, application conditions at the time and different operator application techniques.



## 3-Year **Limited Warranty**

DMMP Ltd. warrants this product free of defects in original workmanship and materials for a period of 3 Years to the end user with the original dated purchase receipt.

If a manufacturing non-conformance is found, DMMP Ltd. will repair or replace the part(s) or product at its discretion at no charge provided the failure is not the result of incorrect installation, mishandling, misuse, tampering, or normal wear and tear as determined by DMMP Ltd.

DMMP Ltd. at its discretion may require that the part(s) or product be returned along with the original purchase receipt at owners' expense for examination and compliance with the terms of this warranty.

Do not return any product without first receiving authorization from DMMP Ltd. To seek remedy under this warranty, contact DMMP Ltd. at +44 (0)1455 825 400 or email us at [info@dmmp.co.uk](mailto:info@dmmp.co.uk) and describe the nature of the manufacturing defect.

### **SPECIFIC LIMITATIONS:**

This warranty covers only the part(s) or product; any labour charges associated with repair or replacement of nonconformances are specifically excluded.

Due to the corrosive nature of most fertilizers and ice melt products, DMMP Ltd makes no warranty against and specifically excludes part(s) or product degradation or failure due to corrosion or its effects.

To negate the effects of corrosive materials on your product, clean and dry your spreader or seeder thoroughly after each use. As a further preventative measure, coat all metal parts with a light oil or silicon spray.

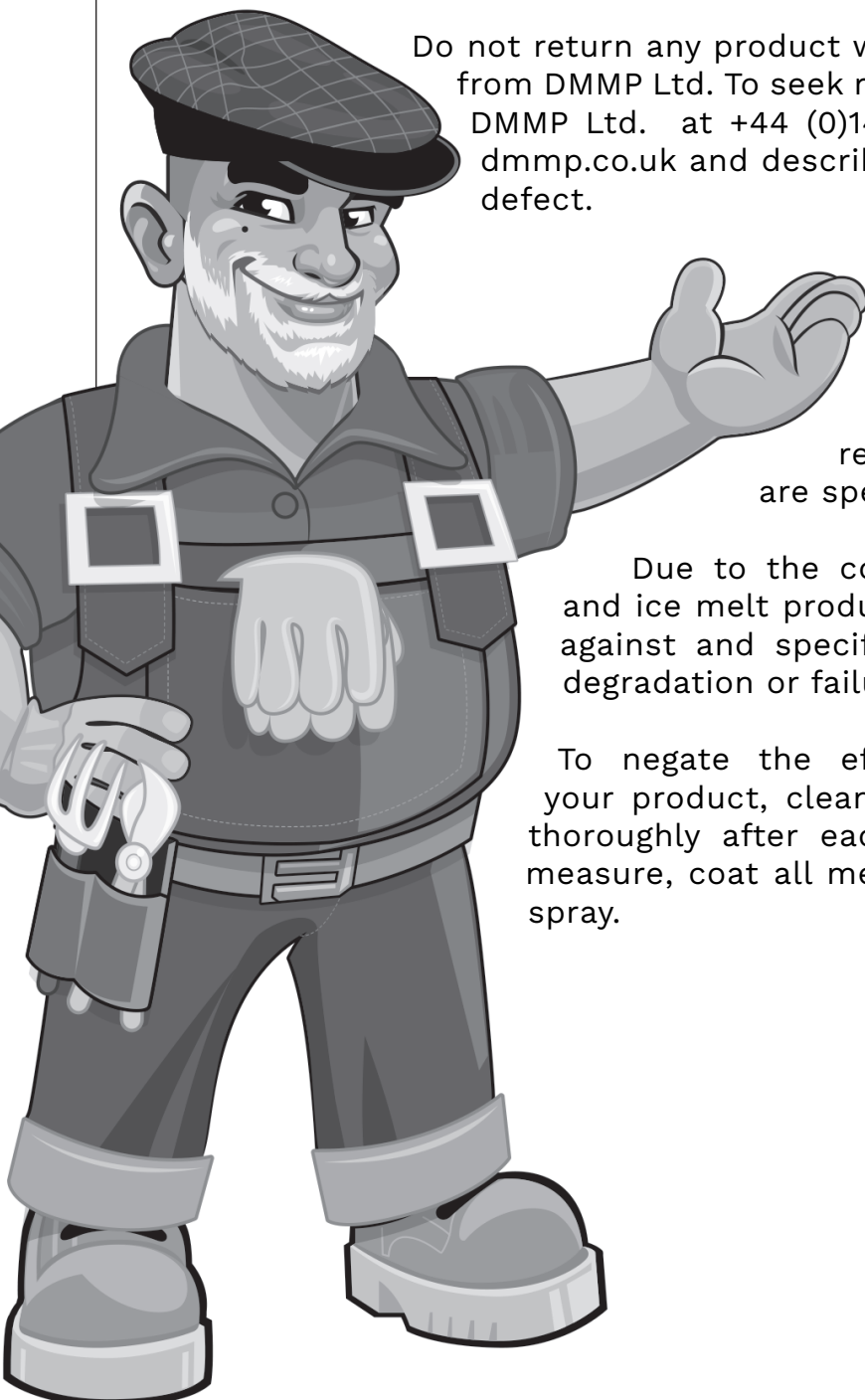

# Other Cresco Products

Product / Season		Unique Selling Points			
 <b>Cresco 1</b>  Code: CR001		Ergonomic arm-rest handle for easy holding		Large 2Kg Hopper	
 <b>Cresco 5</b>  Code: CR005		New heavy duty gearbox		Easy to use on/off system	
 <b>Cresco 10SW</b>  Code: CR10SW		Cushioned on/off lever with solid rod linkage		Large moulded wheels	
 <b>Cresco 20SW</b>  Code: CR20SW		Cushioned on/off lever with solid rod linkage		Pneumatic Wheels	
 <b>Cresco SRS</b> Code: CRSRS		Seed Plate Bag Included with 11 Seed Plates		Strong row marker mounting	
 <b>Heavy Duty Snow Shovel</b> Code: H464P		Powder coated steel tubed handle		Large comfortable ergonomic grip	
 <b>Wide Snow Clearer</b> Code: H611		Steel blade		Steel edge to increase cutting power and longevity	
 <b>3 in 1 Foldable Snow Shovel</b> Code: HZS212		Anodised aluminium head		Telescopic anodised aluminium handle	
 <b>Cresco Snow Blaster</b> Code: H595		Two grip design makes snow removal easy and minimises lifting and stooping		Wave ribbed design reinforces blade strength	
 <b>Polar Tough Snow Plough</b> Code: YH74900		Helps manage snow accumulation		Reduces labour costs compared to a shovel	

